

Complete sand filtration

with six-way valve and pump
on base plate

(Models: FSP350, FSP450, FSP500, FSP650)

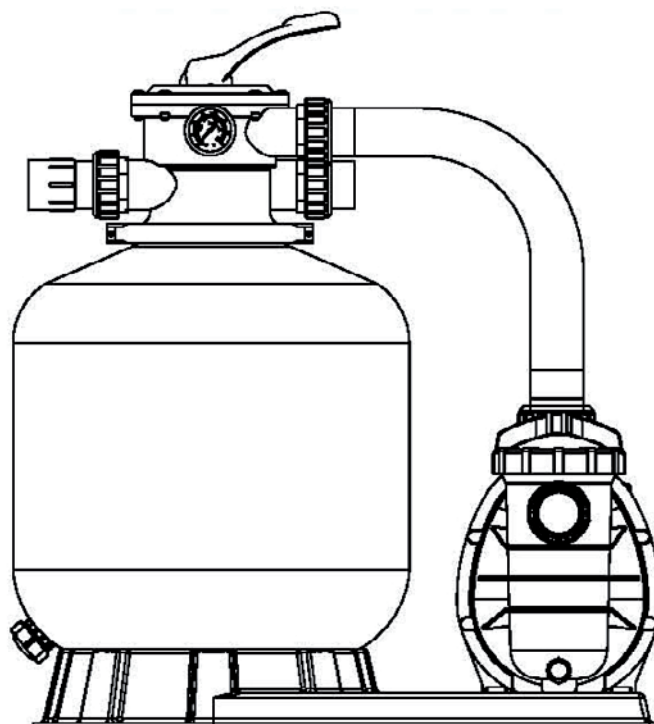

INSTALLATION AND USER GUIDE

Contents

1.	Description of the functions of the filter container, six-way valve, circulation pump	3
2.	Installation	3
3.	Main dimensions	4
4.	Installation/starting up the filtration	4
5.	List of filtration components	5
6.	List of six-way valve components	6
7.	List of circulation pump components	7
8.	Functions of six-way valve and meaning of its positions	9
9.	Warranty conditions	11

Thank you for choosing our product and trusting our company. To help you to get the maximum benefit from using this product, please read these instructions carefully before use and strictly follow the user's manual to prevent damage to the device or unnecessary injuries.

Description of the functions of the filter container six-way valve, circulation pump

1.

The device is used for the maintenance and cleaning of swimming pool water. It consists of a custom filter container, six-way valve and circulation pump. The whole device is mounted on a plastic base which is part of the device. The water is cleaned by the flow of water through the filter container filled with filtration media using a circulation pump. The most widely used filter medium is silica sand. Untreated pool water is sucked through the circulation pump and subsequently drifted through the technology (pipes, fittings, valves) and the six-way valve into its own filter container. Part of the six-way valve is a pressure gauge which is used for visual inspection of impurities in the filter medium. The water passes through the filter medium where the impurities are trapped. Purified water is extruded into the technology through pipes, fittings and circulation nozzles back into the pool. This process of cleaning the pool water is highly efficient, smooth and provides a complete recirculation of the pool water.

Installation of the equipment

2.

If you do not use a professional service to install the device, we recommend to place the filter device as close as possible to the swimming pool shell, however, at least up to a distance of about 5 m. If it is necessary to install the filter device at a greater distance than 5 m contact an authorized service centre. For hassle-free maintenance and service we recommended installing the entire device under the level of the pool water. Proprietary technology (pipes), for both the suction and discharge, must be closed by shut-off valves. We recommend also making the drainage pipes in the place of installation of the device. Drainage pipes can be used for the operation and maintenance of the device. Especially when the reverse reverse is carried out, when a large amount of polluted water is drained into the waste.

CIRCULATION PUMP

The pump and the electric power line should only be installed by qualified and authorized persons.

FILTER CONTAINER

1. First, fill the filter container with the filtration media. Before filling the filter container, place the plastic base in the chosen place and install (attach) the circulation pump. Mount the complete drainages valve at the bottom of the container and tighten it.
2. Remove the clamp flange, and gently pull upwards to remove the six-way valve. Remove the rubber seal from the groove at the neck of the sand container.
3. Cover the central tube with a plastic cover, or other suitable means and slowly pour the filter medium in the necessary quantity (about 3/4 of the sand container). When pouring the media be careful to avoid misalignment of the central tube. Straighten the medium in the container. Remove the plastic cover from the central tube.
4. Carefully clean the groove in the neck of the sand container. Remount the six-way valve including the rubber seal. Apply an appropriate water grease on the seal, we recommend silicon grease.
5. Attach the valve deploy carefully through the opening in its lower part to the central tube. When attaching the valve rotate it slightly. Replace the flange clamp and tighten the screws.
6. Install the pressure gauge. Screw down the pressure gauge including the seals, to which apply grease. Tighten the pressure gauge very carefully and gently screw into the inner plastic fittings.
7. Attach the connecting hose to the circulation pump discharge and to the six-way valve outlet moulding marked PUMP. The connecting hose is provided with fitting and sealing O-rings. Before assembly, apply grease to the O-rings, gently tighten the fittings.
8. Attach the six-way valve connected to the discharge pipe to the moulding marked RETURN. Connect the other technological parts.
9. We recommend that you also connect the six-way valve outlet marked WASTE to a suitable drainage pipe.
10. Irrigate the technology, and check the tightness of all the technology components. If you find water leaks, tighten the connections. It should be noted that all fittings and connections are made of plastic. In the case of excessive tightening of the connecting parts they could be damaged, we recommend you refer to installation experts.

3.

Main Dimensions

maximum water temperature: 40° C
maximum operating pressure: 200 kPa
sand grain size: 0.5 - 0.8 mm

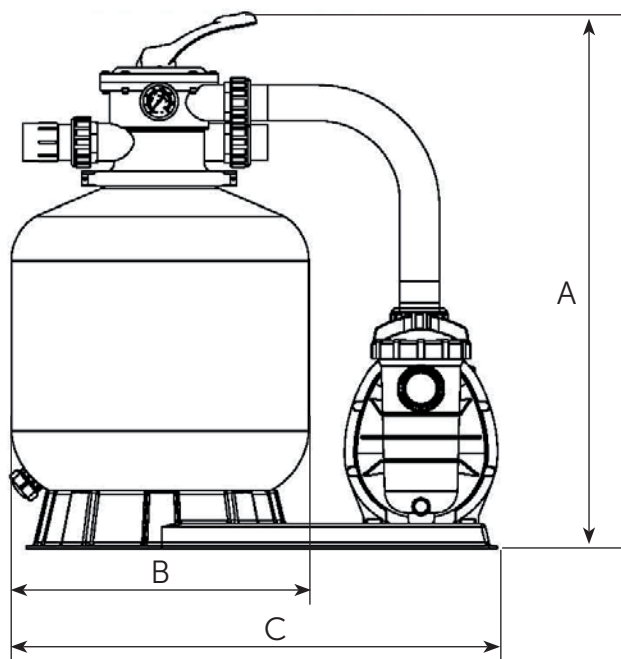

Table of dimensions

Model	Height A (mm)	Diameter B (mm)	Length C (mm)	Sand (kg)	Set flow rate (m³/h)	Power input (kW)	Voltage (V)
FSP350	680	350	555	20	4	0,20	220
FSP450	813	449	760	45	8	0,50	220
FSP500	856	527	760	85	12	0,75	220
FSP650	961	627	760	145	16	1,00	220

4.

Installation/starting the filtration

Before any handling of the six-way valve, especially when switching valve functions, the filter circulation pump must be turned off.

1. Press the lever of the six-way valve downwards and turn it in the position BACKWASH. You should note that when using this valve function a considerable amount of water will flow from the outlet!
2. Irrigate the pump and turn it on according to the instructions (make sure that all suction and reversing pipes are open) to fill the filtration container with water. When the water is running out through the WASTE hose, the system is irrigated. Before selecting any other function, you need to thoroughly rinse the new filter media. Rinsing media may take several minutes; you should count with the loss of pool water. Stop the Rinsing function as soon as clean water flows through the outlet - observe the clean water in the transparent part of the pipeline – vizor, transparent part on the waste pipe.
3. Turn the pump off and set the valve to the position RINSE. Activate the pump and let it run for about half a minute to one minute until the water in the aperture is not clean. Turn the pump off, set the valve back to the FILTER position and re-activate the pump. The filtration is now running in the standard filtration mode and filters off the dirt from the pool water.

4. Check that the water doesn't leak from the system and the filter and if necessary, tighten the connections, screws or nuts.
5. After some time of the filtering of the pool water the pressure gauge will display a higher pressure, this means that the filter medium is clogged with impurities. In this case it is necessary to perform a rinse. When rinsing the filter medium proceed in the same way as described above, including the settling function. Perform the rinsing when the pressure gauge shows a pressure of about max. 1,2 bar.

Note: During the first cleaning of the new pool water it might be necessary to rinse the filter medium more often because this water contains more dirt.

List of filter components

5.

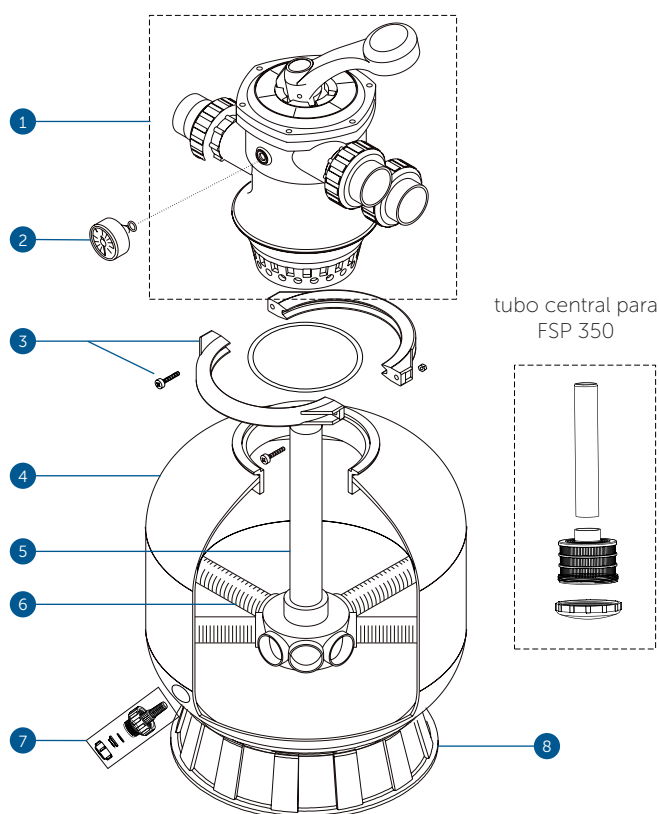

Item	Product Description	Product code
1	six-way valve	1ND02-01-069
2	pressure gauge with O-ring	1ND02-01-019
3	flange clamp and screw with nut	1ND02-01-037
4	filtration container to P450 and FSP450	1ND02-01-022
	filtration container to P500 and FSP500	1ND02-01-023
5	central tube - P350	1ND02-01-047
	central tube - P400	1ND02-01-048
	central tube - P450	1ND02-01-049
	central tube - P500	1ND02-01-050
	central tube - P650	1ND02-01-051
6	water drainage tube - P400-P450	1ND02-01-052
	water drainage tube - P500-P700	1ND02-01-067
7	drainage valve	1ND02-01-056
8	stand under container - P350	1ND02-01-029
	stand under container - P400-P450	1ND02-01-030
	stand under container - P500-P750	1ND02-01-031

6.

List of six-way valve components

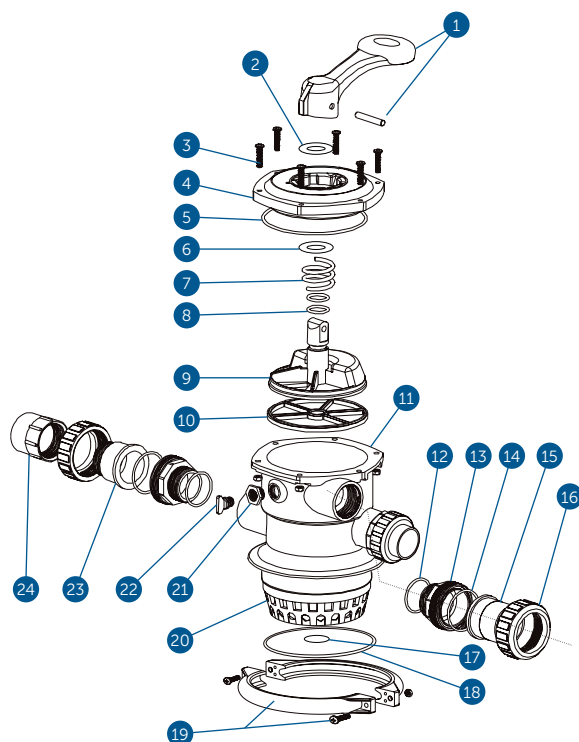

Item	Product Description	Product code
1	lever, lever pin	1ND02-01-025
2	washer	1ND02-01-026
3	screw with nut, cover	1ND01-01-023
4	set cover	1ND02-01-017
5	O-ring cover	1ND02-01-043
6	washer	1ND02-01-027
7	spring	1ND02-01-032
8	revolving wheel O-ring	1ND02-01-041
9	revolving wheel	1ND02-01-035
10	Spider - inner six-way valve seal (individual functions)	1ND02-01-040
11	body-diffuser	1ND02-01-066
12	threaded coupler O-ring	1ND02-01-038
13	threaded coupler pipe fitting	1ND02-01-038
14	threaded coupler O-ring	1ND02-01-038
15	threaded coupler adaptor	1ND02-01-038
16	threaded coupler cap nut	1ND02-01-038
17	O-ring central tube	1ND02-01-045
18	O-ring filter	1ND02-01-044
19	screw with nut, flange clamp	1ND02-01-037
20	6-way valve diffuser - Brilix	1ND02-01-012
21	nut, stopper (threaded part designed for mounting pressure gauge)	1ND02-01-034
22	stopper with O-ring (use in case of pressure gauge failure)	1ND02-01-060
23	waste aperture	1ND02-01-058
24	connector	1ND02-01-046

List of pump components

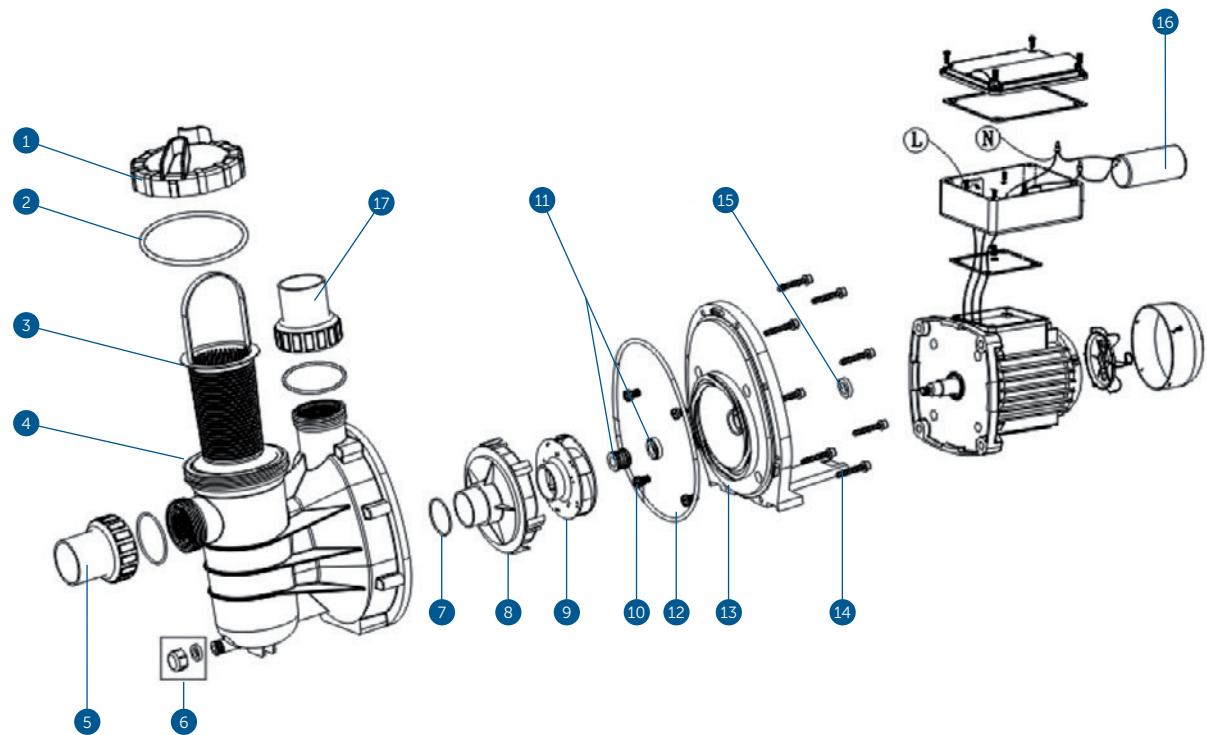

Item	Product description	Qty	Product code
1	FXP pump filter cover	1	1ND01-01-021
2	Seal under the lid	1	1ND01-01-014
3	FXP filter basket	1	1ND01-01-005
4	FXP pump body	1	1ND01-01-013
5	threaded coupler 1.5"	2	1ND01-01-012
6	drainage stopper with O-ring	1	1ND01-01-022
7	O-ring on diffuser	1	1ND01-01-065
8	diffuser	1	1ND01-01-001
9	FXP150 pump turbine	1	1ND01-01-016
	FXP250 pump turbine	1	1ND01-01-017
	FXP370 pump turbine	1	1ND01-01-018
	FXP500 pump turbine	1	1ND01-01-019
	FXP750 pump turbine	1	1ND01-01-020
10	screw M8*16 with washer	4	1ND01-01-024
11	mechanical seal ½"	1	1ND01-01-011
12	O-ring for flange	1	1ND01-01-015
13	FXP pump flange	1	1ND01-01-009
14	screw M6*30	8	1ND01-01-023
15	motor ring washer for FXP	1	1ND01-01-006
16	Condenser for the pump FXP150	1	1ND01-01-025
	Condenser for the pump FXP250	1	1ND01-01-026
	Condenser for the pump FXP370	1	1ND01-01-002
	Condenser for the pump FXP500	1	1ND01-01-003
	Condenser for the pump FXP750	1	1ND01-01-004
17	O-ring	2	1ND02-01-076

Functions of Six-Way Valve and Meaning of its Positions

Valve position	Functions
filtration	filtration and suction
backwash	cleaning the filtration media (reverse flow)
rinse	cleaning the remaining impurities from the filtration after the backwash
waste	lowering the pool water level, suction
recirculation	circulation of water
closed	valve closed

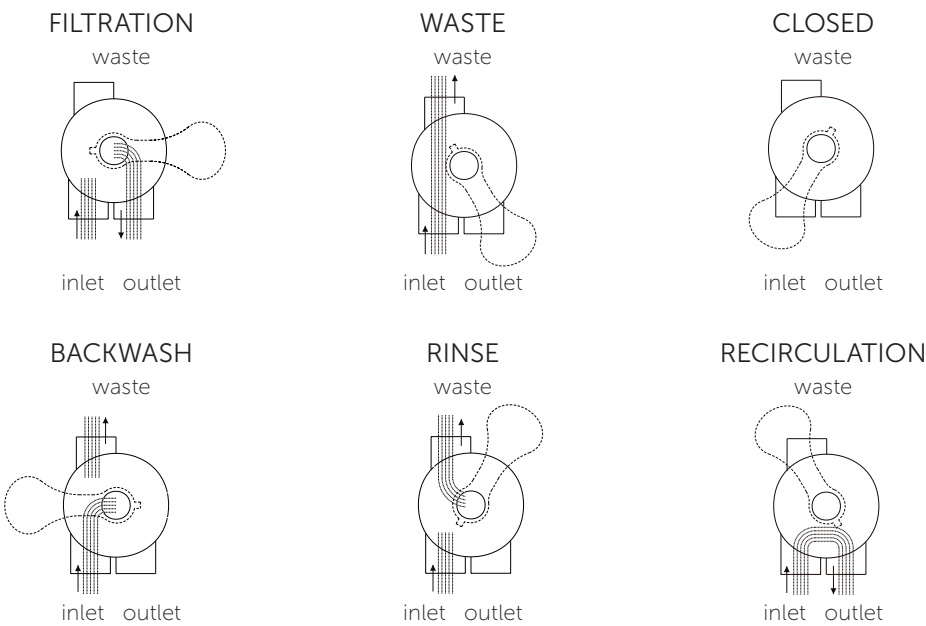

Explanation of functions:

FILTER: Normal operation during cleaning and maintenance of the pool water, purified water passes through the filter medium.

BACKWASH: Cleaning the filter media. With this function, as compared with the filtering function, the direction of the flow of pool water is reversed through the filtration media, the impurities are rinsed out of the container. The period of water purification depends on the degree of impurities in the filter media and can take several minutes. Before running this function it is recommended to fill up at about 1m³ of water to the pool.

Caution: This function is necessary to ensure the drainage of the six-way valve (see Installation / startup).

RINSE: Thorough cleaning of the filtration media, the flow of water is the same as with the filtering.

Caution: When using this function it is necessary to ensure the drainage of water from the six-way valve (see Installation / startup).

WASTE: With this function it is possible to dynamically and rapidly drain the swimming pool water. The drained water is not lead through a filter medium. This function can be used for pool maintenance, while vacuuming. This method of vacuuming is recommended for use in the removal of larger quantities of impurities which settle on the bottom of the swimming pool shell, for instance following the use of flocculating products (flocculants).

Caution: When using this function it is necessary to ensure the drainage of the six-way valve (see Installation / startup).

RECIRCULATION: With this function, the water is guided outside of the filter medium and can be used for filling the filtration system up; any air is displaced by this system.

CLOSED: Water does not flow through the six-way valve. It is used for example in case of the necessity to disassemble the circulation pump technology.

Caution: When using this function the circulation pump must not be running!!

Recommendation: During the winter shutdown, set the lever of the six-way valve to any intermediate position to avoid excessive wear and tear on internal seals of the Spider. Never switch on a feature of the six-way valve when the pump is running!

CAUTION: If there is a faulty valve, contact an authorized service centre. We do not recommend removing the valve yourself. Dismantling of the valve must be done by a person with technical training from the manufacturer. If, despite the aforementioned, you decide to dismantle the valve, proceed with caution, there is a risk of injury.

WARNING

- Turn the pump off before changing the position of the six-way valve
- Never operate this device without water.
- Never connect the filter directly to the water source from the water supply system. The water pressure from the water supply system might be much higher than the maximum pressure of the filter.
- Never turn the pump on if the position of the six-way valve is set to the closed position or if pipes of the circulation system are impassable. There is a risk of a higher pressure than the working pressure which can lead to the damage, cracking, separation of the six-way valve cover that might cause injuries or damage to property.
- Do not clean the filter cover or the filter container with a solvent, it could damage its surface (tarnishing, transparency, etc.)
- Clean the pump hair filter and the skimmer basket regularly in order to prevent damage to the pump and ensure the proper operation of the system.
- Do not unscrew flanged connectors if the pump is running.
- As all connectors are equipped with seals there is no need to screw the nuts too tightly, it could damage the plastic components.

Warranty conditions

Liability period for defects

The liability period for defects is determined by law for 24 months.

Safe liquidation of the product at the end of its useful life

Once the product's useful life has ended, please ensure its ecological liquidation by a specialised company.

Complaints and Service

Claims are governed by the relevant acts on consumer protection.
In the event of any irreparable defects, please contact your supplier in writing.

Date

Supplier

Thank you
for using ALBIXON
products